

Reflex Sight User's Manual

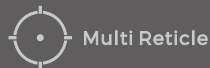

Multi Reticle

www.holosun.com

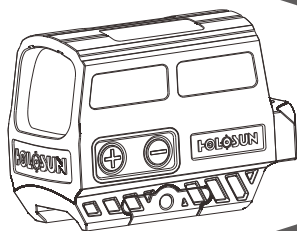

Thank you for purchasing the HOLOSUN HS512C Reflex Sight. The HS512C is an enclosed reflex sight with circle dot reticle housed in an Aluminum body. It features a motion sensor and dual power sources including both solar and battery power. Before operation, please read the User Manual carefully.

Model

HS512C



RED
Circle Dot

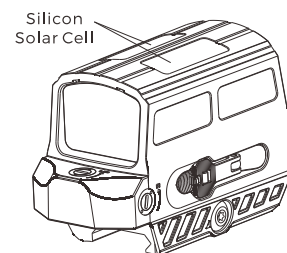

Fig 1 HS512C Reflex Sight

Important Notices

1. Ensure that the firearm has no magazine inserted and an empty before device installation or installing a new battery.
2. Please keep the packaging should you need to make a warranty claim.

Objective Lens

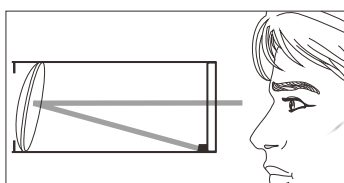

Fig2

Reflex sights have an objective lens that is positioned at an angle in order to properly reflect the reticle/dot.

The objective lens must be perpendicular to the LED which projects the light that is reflected off of the front lens and produces the reticle/dot you see.

Features

1. Advanced LED technology: Up to 20,000 hours battery life using the Circle-Dot or 50,000 hours using the dot only.
2. Advanced Super Solar Technology: Now allows for use in low light conditions.
3. Parallax free with unlimited eye relief
4. Multi Reticle System : 2MOA Dot only, 65MOA Circle-only, or Circle-Dot options.
5. Shake Awake sensor.
6. 10 Daylight & 2 Night Vision compatible brightness settings.
7. Fully enclosed housing design.
8. 1.41" Center Dot Height (Absolute Co-witness).
9. Protective adjustment turret shrouds
10. Quick release battery tray
11. Waterproof: IP67.

Multi Reticle System

The reticle for this sight is a 2MOA dot centered in a 65MOA circle with four positioning points.

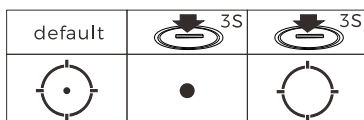

Fig 3

The diameter of the circle reticle represents approximately 5' 5" at 100 yards (170cm at 100m).

Battery

1. One high quality CR2032 Lithium battery is included with your purchase.
2. A high quality battery can power the Circle-Dot for up to 20,000 hours or the 2MOA dot only for up to 50,000 hours at a mid setting.

Caution: Do not use a rechargeable battery.

3. Removal and installation of the battery tray (Fig-4)

- 1) Push the clamp lock forward and simultaneously lift the clamp handle.
- 2) Turn the clamp handle counterclockwise 90 degrees. Then pull the handle outward to remove the battery tray.
- 3) Repeat the steps above in reverse to install the battery tray.

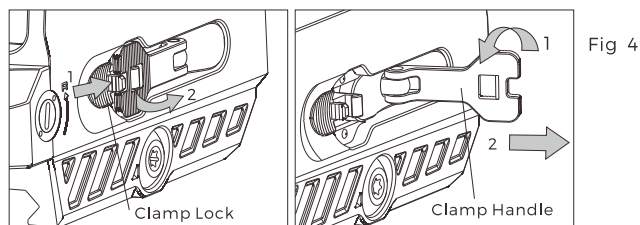

Fig 4

4. Battery replacement (Fig-5)

- 1) Remove the battery tray from the optic and remove the spent battery from the battery tray.
- 2) Insert a new battery into the battery tray making sure the "-" side faces up and the "+" faces down.
- 3) Reinsert the battery tray and lock the clamp handle down.

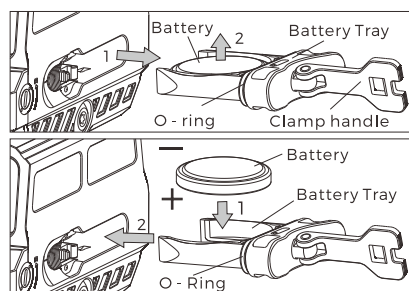

Fig 5

Caution: The loss or damage to the battery tray o-ring seal may allow moisture into the compartment causing damage to the sight.

Installation on your Firearm

1. The HS512C is compatible with any firearm with a Picatinny mounting rail. If the firearm does not have a Picatinny rail, contact a qualified gunsmith.

2. Using the included T10 Torx tool, loosen the cross bolt and then attach the sight into the Picatinny rail in an appropriate position. Apply forward pressure towards the muzzle and tighten the clamp bolt. (Fig6)

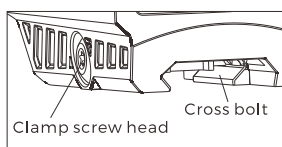

Fig 6

Zero setting

- 1) The sight has been factory zeroed to approximately 25 yards.
- 2) The elevation adjustment is located on top of the rear section of the housing and the windage adjustment is located on the right side of the housing. Windage and Elevation adjustments can be made using the included tool. (see Fig8).
- 3) Windage & Elevation adjustments have a 0.5MOA per click value.
- 4) Adjust the Elevation turret counterclockwise to move the point of impact UP. Adjust the Windage turret counterclockwise to move the point of impact to the RIGHT. Turning either turret clockwise moves the point of impact in the opposite direction.
- 5) The maximum adjustment range is ± 50 MOA from center. Caution: Do not try to over rotate the adjustment turrets. If you feel the adjustment turrets can not be rotated, this indicates you have reached the adjustment limit. Further adjustment may cause damage. If the required adjustment range is beyond the limits, consider adding an extra spacer between the device and mounting rail to allow for additional adjustment.

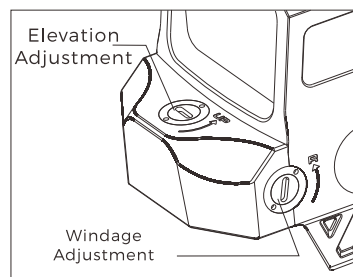

Fig 8

Sight Operation

The HS512C has two operating modes: Auto mode and Manual mode.

1. To Power ON (see Fig7): Press and release either brightness button ("+" or "-") to turn on the sight.
2. To Power OFF: Press the "+" and "-" buttons simultaneously to turn the power and motion sensor off.
3. Operation Mode: Two operation modes are available: Auto mode and Manual mode.

1) Auto mode (default) - A two-way power supply operates the HS512C. Depending on ambient lighting conditions the HS512C will switch between battery and solar cell power automatically for operation in all lighting conditions.

Auto Mode Operation:

- a) In Auto mode, the brightness of the reticle is automatically adjusted to match varying lighting conditions.
- b) The battery will provide for power if the solar cell cannot drive the reticle due to low light conditions.
- c) If lighting is low enough, the sight will automatically switch to the battery. While running on battery, you can adjust the reticle brightness using the "+" and "-" buttons to switch between brighter and dimmer brightness levels.

2) Manual Mode:

- a) To change to Manual mode, hold the "+" button down for 3 seconds and release when you see the reticle blink once.
 - b) Brightness adjustment: There are 12 reticle brightness settings in manual mode. Press the "+" or "-" buttons to increase or decrease the brightness.
 - c) Multi-Reticle System: Holding the "-" button for about 3 seconds will cycle between 3 reticle options: Circle-Dot, Dot Only, Circle Only.
- 3) Return to Auto mode: To change back to Auto mode press the "+" button for 3 seconds and release when you see the reticle blink once.

4. Sleep Timer Mode:

- 1) The HS512C will automatically enter into sleep mode after 10 minutes of no movement. Sleep mode powers the reticle OFF.
- 2) The slightest movement of the sight will awaken the reticle returning to the same brightness setting.
- 3) The default sleep timer setting is 10 min, with 3 additional settings.
 - i. Press and hold the "+" button for 10 seconds to enter the sleep timer setting mode. There are 4 options: 10 min, 1h, 12h or the sleep mode is disabled.
 - ii. Press the "+" or "-" button to select a setting. The LED will blink (1=10 min, 2=1h, 3=12h, or 4=disabled sleep mode).
 - iii. Press the "+" and "-" buttons simultaneously to save the timer setting and power off the sight.

5. NOTE:

- 1) Memory Function: This sight will remember the last saved brightness setting when powered on and off.
- 2) Low Battery Warning: If the battery voltage falls below 2.2VDC, the reticle will blink once every two seconds.

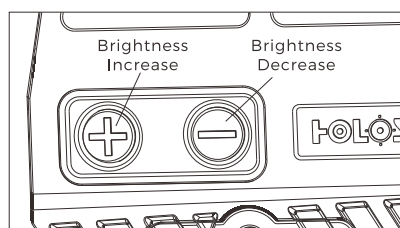

Fig7

Maintenance & care

This device is a precision instrument that deserves reasonably cautious care. The following tips are provided to ensure long lasting use of the sight. The optical system includes the objective lens and ocular lens which are multi-coated optical glass. When cleaning the lenses, blow away any dust on the surface, wet the lens with lens cleaner or clean water, wipe fingerprints and oil stains with a lens tissue, soft cotton, or microfiber cloth. No special maintenance is needed for housing surface. Avoid touching the glass surface with a dry cloth or tissue paper. No organic solvents such as alcohol, acetone should be used. Do not try to dismantle the device as the internal parts are specially cleaned and sealed and with anti-fog treatment. Any such attempt will void the warranty. If repair is needed, please call our customer service center, visit our website, or send us an email.

Limited Warranty

We provide a limited lifetime warranty from the date of purchase on parts and workmanship to the original purchaser. At our sole discretion, we will repair or replace products found to be defective under normal use without charge, excluding any delivery costs, which will be born by purchaser. We will not be liable for incidental, consequential, or special damages arising out of or in any connection with the use or performance of this product. This warranty is void if the product has been misused, modified, neglected, or disassembled prior to its return. Please refer to <http://holosun.com> for current and complete warranty information and other conditions.

HS512C Reflex Sight

Holosun
Holosun Technologies Inc.
www.holosun.com
Customer Service

Phone: (909) 594-2888
Fax: (909) 598-4888
Email: warranty@holosun.com